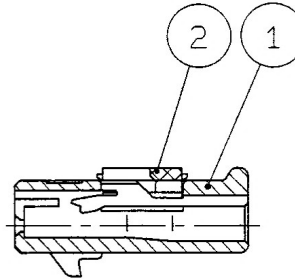
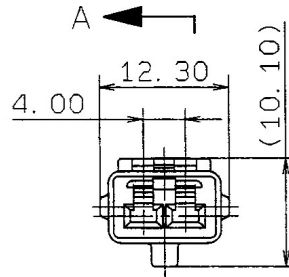

TABLE 1

YAZAKI SUB ASSEMBLY PART NO.	NO.	YAZAKI PART NO.	MATERIAL	COLOR	△QTY.
7283-8922 ETC.	①	SEE TABLE 2	△ HPA	SEE TABLE 2	1
	②	7157-4092	△ HPA	NATURAL	1

TABLE 2

YAZAKI SUB ASSEMBLY PART NO.	YAZAKI PART NO.	COLOR
7283-8922. □	7183-8922	NATURAL
7283-8922-10. □	7183-8922-10	DARK GRAY
7283-8922-30. □	7183-8922-30	BLACK
7283-8922-40. □	7183-8922-40	LIGHT GRAY
7283-8922-50. □	7183-8922-50	ORANGE
7283-8922-60. □	7183-8922-60	GREEN
7283-8922-80. □	7183-8922-80	BROWN
7283-8922-90. □	7183-8922-90	BLUE



SEC. A-A

## 注 記

1. 嵌合相手品番 : 7282-8922 ETC.  
2. 適用端子品番 : 7116-4020 ETC.

## NOTES

1. MATING PART NO. : 7282-8922 ETC.  
2. APPLICABLE TERMINAL PART NO. : 7116-4020 ETC.

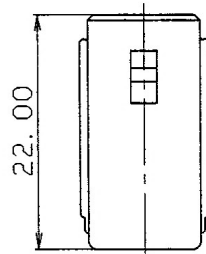

ISSUE MARK

				CUSTOMER				MATL. SPEC.				TREAT. & FIN.			
				CUSTOMER PART NO.				SEE TABLE 1							
				CUSTOMER DWG NO.				NAME				090II 2P CONNECTOR			
				OFFICE				TRIAL PART NO.				SUB ASSEMBLY FEMALE			
				VENDOR											
				VENDOR NO.				PART NO.				7283-8922 ETC.			
								CH. CODE							
								DWG NO.				7283-8922:R			
								SET DWG NO.							
								YAZAKI CORPORATION							