

B

A

B

A

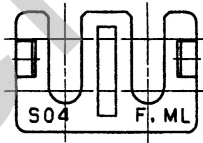
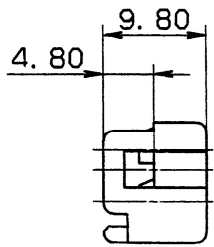
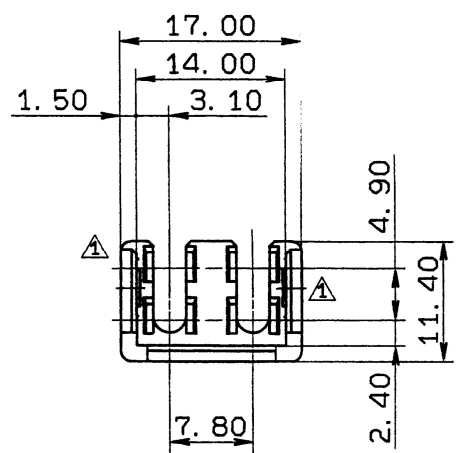

注 記

- 1. 適用オスハウジング品番: 7122-1649-90
- 2. 適用メスハウジング品番: 7123-1649-90

△ NOTES

- 1. APPLICABLE MALE HOUSING NO. : 7122-1649-90
- 2. APPLICABLE FEMALE HOUSING NO. : 7123-1649-90

ISSUE MARK

								CUSTOMER [△]				MATL. NYLON 6			TREAT.		
								CUSTOMER PART NO.				SPEC. (LIGHT BLUE)			& FIN.		
90.02.09 RENEW AND CHANGED FORM C89-M246 H. Y								OFFICE [△]				NAME [△] REAR HOLDER FOR					
LET DATE REVISION RECORD NO. CHKD								VENDOR [△]				STD LIB NO.			S04F, ML		
GENERAL TOLERANCE								VENDOR NO.				PART NO. 7157-6042-90					
	10MAX	50MAX	100MAX	250MAX	250OVR	ANGLE	ECCENT	DWG TYPE	DWG SOURCE	DWG DATE	UNIT	SCL	ANGLE				
A	±0.15	±0.2	±0.3	±0.5	±0.75	±30'	0.1	R	RENEW	83.08.02	mm	2/1	3				
B	±0.2	±0.3	±0.55	±0.95	±1.4	±30'	0.1	APPROVED	CHECKED	CHECKED	DESIGN	DRAWN	DWG NO. [△] 7157-6042-90:R		TRIAL PART NO.		
◎	±0.3	±0.5	±0.8	±1.4	±2	±30'	0.15	SPECIFIED		WEIGHT							
								g		90.2.13		90.2.13		90.2.9		83.09.09 90.02.09	
								YAZAKI		CORPORATION							