

YAZAKI NO.	COLOR
7123-1300	NATURAL
△ 7123-1300-10	DARK GRAY
7123-1300-30	BLACK
7123-1300-40	GRAY
7123-1300-50	ORANGE
7123-1300-60	GREEN
7123-1300-70	YELLOW
7123-1300-80	BROWN
7123-1300-90	BLUE

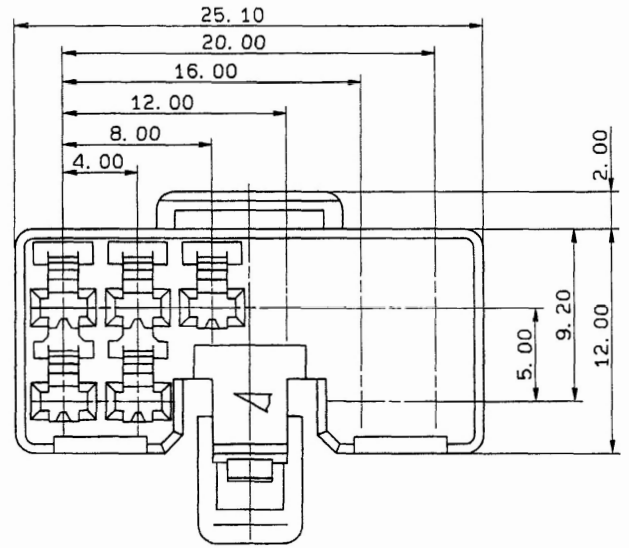

注 記

1. 嵌合相手品番: 7122-1300 ETC.
2. 適用端子品番: 7116-1180 ETC.

NOTES

1. MATING PART NO. :7122-1300 ETC.
2. APPLICABLE TERMINAL NO. :7116-1180 ETC.

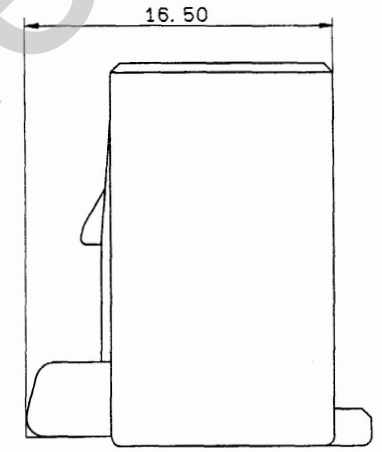
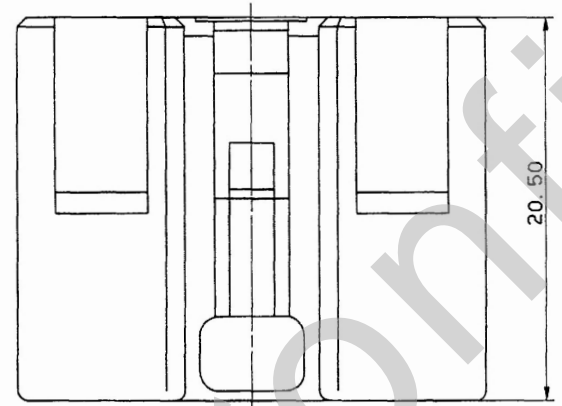

LET	DATE	REVISION RECORD	NO.	CHKD
△	90.01.13	ADDED PART NO.	BMC-0450	H. Y
	88.07.01	NEW	BMC-3001	S. Y

GENERAL TOLERANCE								
	10MAX	50MAX	100MAX	250MAX	2500VR	ANGLE	ECCENT	
A	±0.15	±0.2	±0.3	±0.5	±0.75	±30'	0.1	
B	±0.2	±0.3	±0.55	±0.95	±1.4	±30'	0.1	
◎	±0.3	±0.5	±0.8	±1.4	±2	±30'	0.15	
SPECIFIED							WEIGHT	2.8g

CUSTOMER		MATERIAL		TREAT.	
CUSTOMER PART NO.	CUSTOMER DWG NO.	SPEC.	NYLON	& FIN.	
OFFICE		NAME 10P 090 FEMALE HOUSING			
VENDOR		STDLIB NO.			
VENDOR NO.		PART NO. 7123-1300 ETC.			
DWG TYPE	DWG SOURCE	DWG DATE	UNIT	SCL	ANGLE
R	NEW	88.06.16	mm	5/1	3
APPROVED	CHECKED	CHECKED	DESIGN	DRAWN	
S. INABA		KANeko		S. INABA	
DWG NO. 7123-1300:R		TRIAL PART NO.			
YAZAKI CORPORATION					

1

2

3

4

5