

B

B

A

A

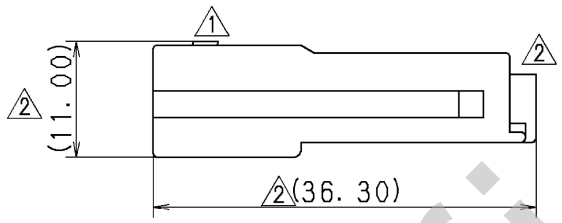
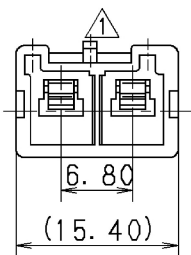
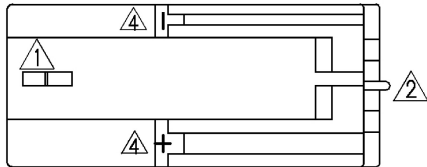

NOTES

- 1. MATING PART NO. :7123-1920
- 2. APPLICABLE TERMINAL NO. :7114-1230, 7114-1231
- 3. APPLICABLE REAR HOLDER NO. :7157-6822

注記

- 1. かん合相手品番:7123-1920
- 2. 適用端子品番:7114-1230, 7114-1231
- 3. 適用リヤホルダ品番:7157-6822

△	10. 11. 15	CHANGED PART NAME	C10-ZB31	R. E				
△	01. 06. 15	ELIMINATE REAR HOLDER COLOR NO.	C01-X575	H. Y				
△	99. 06. 14	CHANGED NOTE	C99-L830	O. S				
△	89. 11. 22	ADD. THE STAMP	C89-7550	M. K				
△	89. 04. 05	リヤホルダ色変更	C89-6532	M. K				
△	84. 11. 12	CHANGED FORM, RENEW	C84-1082	K. S				
△	84. 01. 21	CHANGED FORM	C84-0110	K. S				
△	83. 03. 04	NEW	C83-0339	K. S				
LET	DATE	REVISION RECORD	NO.	CHKD				
GENERAL TOLERANCE								
	10MAX	50MAX	100MAX	250MAX	2500VR	ANGLE	ECCENT	
A	±0. 15	±0. 2	±0. 3	±0. 5	±0. 75	±30'	0. 1	
B	±0. 2	±0. 3	±0. 55	±0. 95	±1. 4	±30'	0. 1	
C	±0. 3	±0. 5	±0. 8	±1. 4	±2	±30'	0. 15	
SPECIFIED					MASS			

CUSTOMER	MATL. SPEC.	PA66 (NATURAL)	TREAT. & FIN.
CUSTOMER PART NO.	CUSTOMER DWG NO.		
OFFICE	TRIAL PART NO.	NAME △ T TYPE HOUSING	
VENDOR		2P MALE (W)	
VENDOR NO.		DWG TYPE	DWG SOURCE
		R	NEW
		DWG DATE	UNIT
		83. 03. 04	mm
		SCL	ANGLE
		2/1	3
		APPROVED	CHECKED
		S. MIZUSE	R. CABANGAL
		10. 11. 15	10. 11. 15
		DESIGN	DRAWN
		K. SAKURAI	R. EVANGELISTA
		83. 02. 25	10. 11. 15

ISSUE MARK
PART NO. 7122-1920
CH. CODE
DWG NO. △ 7122-1920:R
SET DWG NO.
YAZAKI CORPORATION

