

YAZAKI PART NO.	COLOR
7122-1300	NATURAL
7122-1300-10	DARK GRAY
7122-1300-30	BLACK
7122-1300-40	LIGHT GRAY
7122-1300-50	ORANGE
7122-1300-60	GREEN
7122-1300-70	YELLOW
7122-1300-80	BROWN
7122-1300-90	BLUE

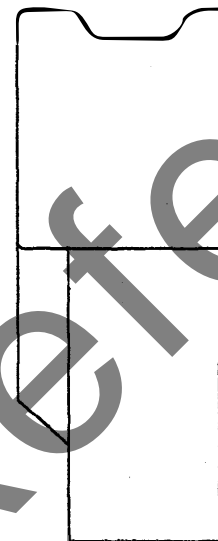
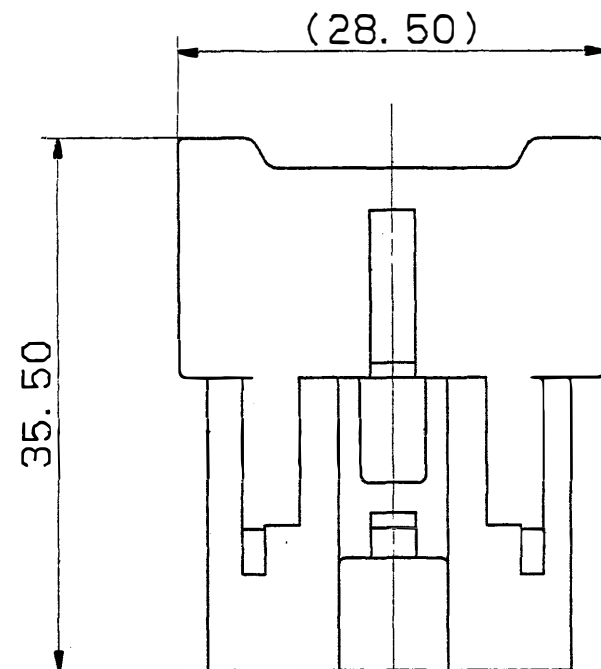
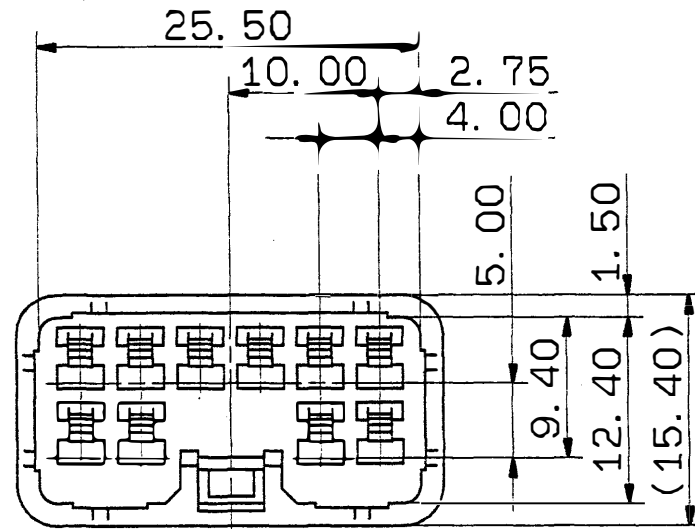

注記

- 1. 適用端子品番: 7114-1170 ETC.
- 2. 嵌合相手品番: 7123-1300 ETC.

NOTES

- 1. APPLICABLE TERMINAL NO. : 7114-1170 ETC.
- 2. MATING PART NO. : 7123-1300 ETC.

ISSUE MARK

CUSTOMER										MATL. SPEC.				TREAT. & FIN.	
CUSTOMER PART NO.					CUSTOMER DWG NO.					66NYLON					
OFFICE										NAME				10P 090 MALE HOUSING	
VENDOR										TRIAL PART NO.					
VENDOR NO.										PART NO.				7122-1300 ETC.	
GENERAL TOLERANCE										DWG TYPE				R	
APPROVED										DWG SOURCE				NEW	
CHECKED										DWG DATE				94.05.26	
CHECKED										UNIT				mm	
DESIGN										SCL				2/1	
DRAWN										ANGLE				3	
KANNEKO										PART NO.				7122-1300 :R	
KUZUNO										DWG NO.				7122-1300 :R	
YAZAKI CORPORATION										YAZAKI CORPORATION					