

PART NO. AND CH. CODE	1		2				WIRE SIZE	MATERIAL
	$\Delta 6$ W1 ± 0.4	$\Delta 6$ W2 ± 0.4	$\Delta 6$ H1	$\Delta 6$ H2	A	B		
7116-4020, [B] $\Delta 5$ (7B16-4020, [B])	2.30	3.60	(2.19)	(3.19)	3.00	6.20	$\Delta 10$ CHFUS 0.35~AVS 0.50 EQUIVALENT	$\Delta 9$ BRASS (t=0.25)
7116-4021, [B] $\Delta 5$ (7B16-4021, [B])	3.00	4.50	(2.91)	(3.89)	4.00	7.20	$\Delta 10$ CHFUS 0.75~AVS 1.25 EQUIVALENT	$\Delta 9$ BRASS (t=0.25)
7116-4022, [B] $\Delta 5$ (7B16-4022, [B])	4.20	4.50	(4.06)	(3.89)	4.00	7.20	AVSS 2 EQUIVALENT	$\Delta 9$ COPPER ALLOY (t=0.25)

B

注記

- $\Delta 5$ 1. () 内品番は、エアバッグ (A/B) 回路及び特別
管理回路に使用する時に適用すること。
- $\Delta 10$ 2. 取扱説明書No. YPES-15-080

NOTES

- $\Delta 5$ 1. PART NUMBERS IN PARENTHESIS SHALL BE USED FOR AIR BAG (A/B)
CIRCUITS AND OTHER CIRCUITS DESIGNATED FOR SPECIAL MONITORING.
- $\Delta 10$ 2. HANDLING MANUAL NO. YPES-15-080

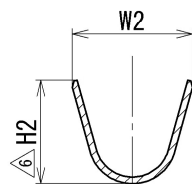

SEC. Q-Q

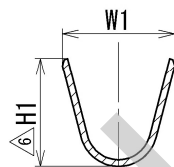

SEC. P-P

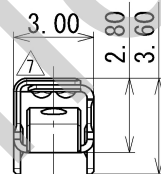

$\Delta 9$ X
DISTINGUISH OF STAMP
識別用の刻印 (□0.8)

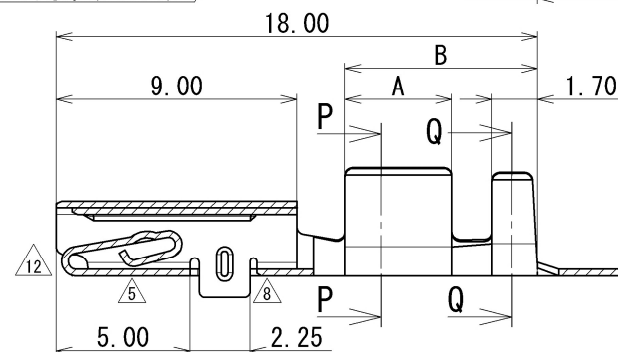
 $\Delta 9$ SEC. X-X

3

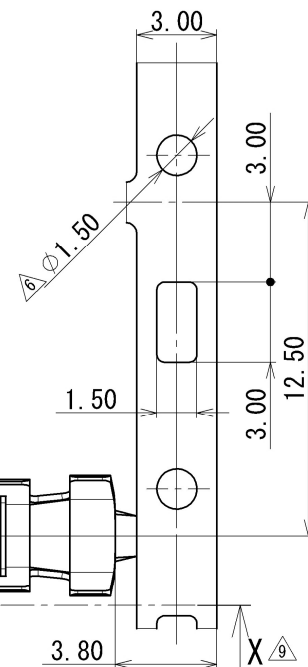

A

$\Delta 12$	2016/07/20	DRAWING MAINTENANCE	C16-P309	M. S
$\Delta 11$	2014/01/14	ADDED DISTINGUISH OF STAMP	C14-Z020	A. D
$\Delta 10$	2012/02/21	CHANGED NOTES, ETC.	C12-Z280	E. I
$\Delta 9$	2005/11/10	CHANGED PART NAME, ETC.	C05-ZF20	T. O
$\Delta 8$	2001/06/07	CHANGED PART NAME & FORM, [B]	C01-X544	A. T
$\Delta 7$	2000/11/08	CHANGED FORM & DIMENSION	C00-M342	Y. S
$\Delta 6$	1998/07/18	CHANGED DIMENSION & ADDED NOTE	C97-N452	H. K
$\Delta 5$	1996/10/28	CHANGED FORM & ADDED A/B PART NO., [A]	C96-M845	H. K
$\Delta 4$	1993/02/23	RENEW	C93-6226	I. I
$\Delta 3$	1990/07/31	CHANGED FORM	C90-6983	K. O
$\Delta 2$	1990/07/02	CHANGED FORM	C90-L752	K. O
$\Delta 1$	1989/03/17	誤記訂正	C89-6441	A. H
	1988/08/24	NEW	8MC-1022	A. H

LET	DATE	REVISION RECORD	NO.	CHKD			
GENERAL TOLERANCE							
	10MAX	50MAX	100MAX	250MAX	2500VR	ANGLE	ECCENT
A	± 0.15	± 0.2	± 0.3	± 0.5	± 0.75	$\pm 30'$	0.1
B	± 0.2	± 0.3	± 0.55	± 0.95	± 1.4	$\pm 30'$	0.1
(C)	± 0.3	± 0.5	± 0.8	± 1.4	± 2	$\pm 30'$	0.15
SPECIFIED							MASS

CUSTOMER	CUSTOMER PART NO.	CUSTOMER DWG NO.
OFFICE	TRIAL PART NO.	
VENDOR	VENDOR NO.	
DWG TYPE	DWG SOURCE	DWG DATE
R	NEW	1993/02/23
UNIT	SCL	ANGLE
mm	$\Delta 6$ 5:1	3
APPROVED	CHECKED	CHECKED
S. SUZUKI	M. NAGANO	
DESIGN	DRAWN	
M. TSUJI	M. SUZUKI	
2016/07/20	2016/07/20	1987/07/27
		2016/07/20

MATL. SPEC.	SEE TABLE	TREAT. & FIN.	TIN PLATING
NAME	$\Delta 9$ 2.3 II TERMINAL FEMALE		
PART NO. CH. CODE	7116-4020 ETC. $\Delta 5$ (7B16-4020 ETC.)		
DWG NO.	7116-4020:R	SET DWG NO.	
YAZAKI CORPORATION			

1

2

3