

YAZAKI PART NO.	A	B	C	D	E	WIRE SIZE
7116-2641-02 (7B16-2641-02)	3.5	3.7	4.9	5.5	1.1	AV 0.85~2
7116-2642-02	4.5	4.7	5.9	6.5	1.4	AV 3

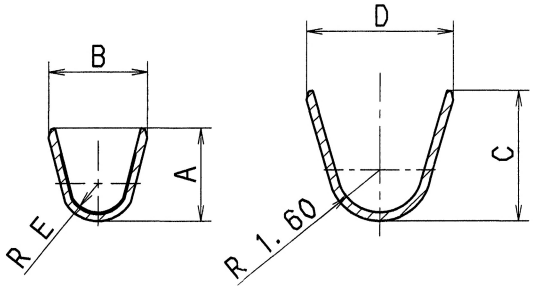
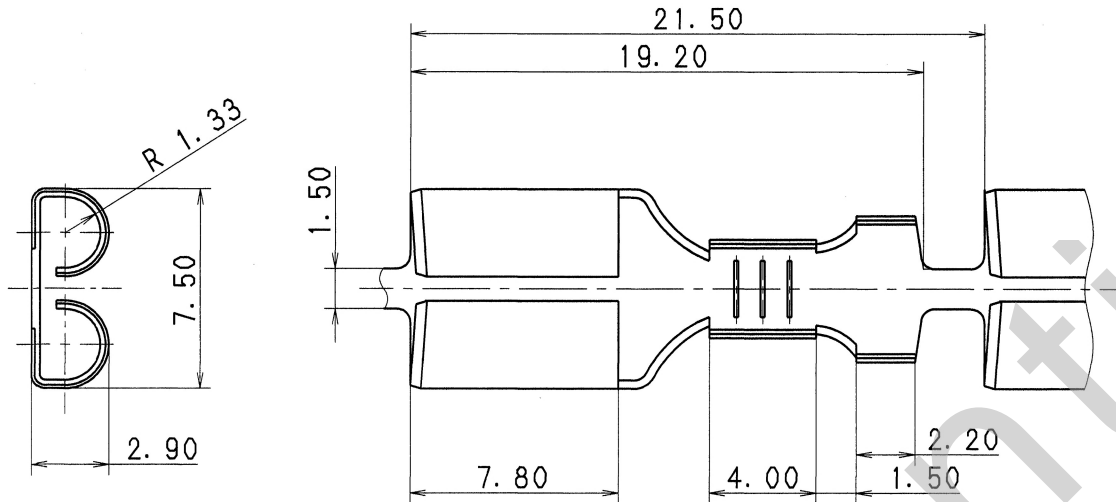

SEC. F-F SEC. G-G

注記

- 1. ()内の品番はA/B回路及び特別管理回路に使用すること。
- △2. 取扱説明書No. YPES-15-086, YPES-15-099

NOTES

- 1. PART NUMBERS IN PARENTHESIS SHALL BE USED FOR AIR BAG (A/B) CIRCUITS AND OTHER CIRCUITS DESIGNATED FOR SPECIAL CONTROL.
- △2. HANDLING MANUAL NO. YPES-15-086, YPES-15-099

ISSUE MARK

								CUSTOMER				MATERIAL SPEC.			TREAT. & FIN.					
								CUSTOMER PART NO.				CUSTOMER DWG NO.			BRASS t=0.32			TIN PLATING		
△	2017/01/25	CHANGED PART NAME, ETC.		C17-Z019	A. Q							NAME △6.3 TERMINAL FEMALE								
	1997/01/16	NEW		C97-L056	H. K			OFFICE				TRIAL PART NO.								
LET	DATE	REVISION RECORD		NO.	CHKD			VENDOR				-----								
GENERAL TOLERANCE								VENDOR NO.												
	10MAX	50MAX	100MAX	250MAX	250OVR	ANGLE	ECCENT	DWG TYPE	DWG SOURCE	DWG DATE	UNIT	SCL	ANGLE	PART NO. 7116-2641-02 ETC. (7B16-2641-02)						
A	±0.15	±0.2	±0.3	±0.5	±0.75	±30'	0.1	R	NEW	1997/01/16	mm	5:1	3	CH. CODE						
B	±0.2	±0.3	±0.55	±0.95	±1.4	±30'	0.1	APPROVED	CHECKED	CHECKED	DESIGN	DRAWN		DWG NO. 7116-2641-02:R						
©	±0.3	±0.5	±0.8	±1.4	±2	±30'	0.15	S. SUZUKI		M. NAGANO		TAKENOUCHI		A. QUIROL		SET DWG NO.				
SPECIFIED								MASS				YAZAKI CORPORATION								
								2017/01/25				2017/01/25		1981/08/17		2017/01/25				