

PART NO. AND CH. CODE	H ₁	$\Delta W_{1 \pm 0.4}$	H ₂	$\Delta W_{2 \pm 0.4}$	X	Y	Z	WIRE SIZE
7114-6045	$\Delta(3.34)$	3.60	$\Delta(4.93)$	5.80	0	0	0	AVS 0.5~AVS 1.25 EQUIVALENT
7114-6046	$\Delta(4.62)$	4.90	$\Delta(6.10)$	7.40	0	0	0	AVS 2~AVS 3 EQUIVALENT
7114-6047	$\Delta(6.48)$	6.80	$\Delta(8.29)$	9.90	1.10	4.00	5.50	AVS 5~AV 8 EQUIVALENT

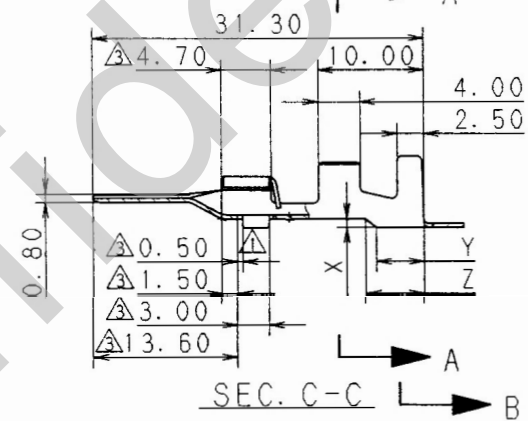
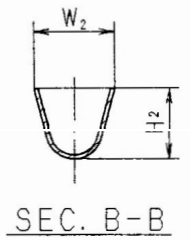
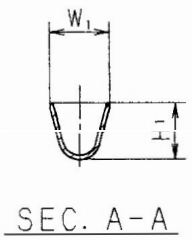
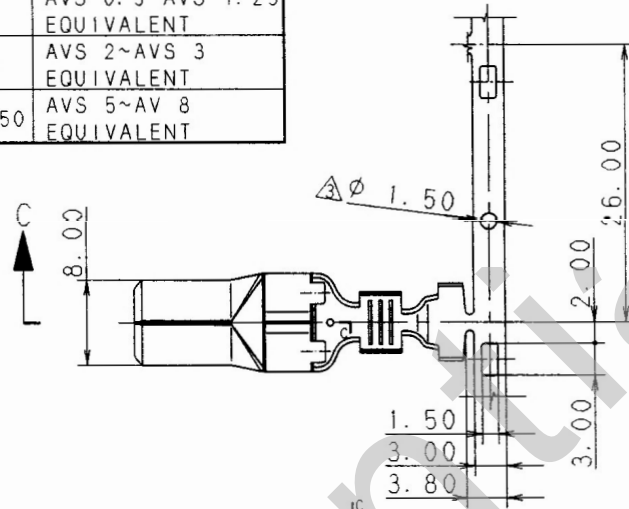
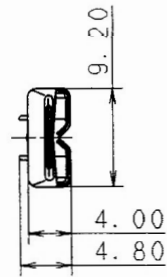

SEC. A-A

SEC. B-B

SEC. C-C

注記

- 1. 嵌合相手品番: 7116-6045 ETC.
- Δ 2. 適用寸公差品番: 7158-3022-80 ETC.

NOTES

- 1. MATING PART NO. : 7116-6045 ETC.
- Δ 2. APPLICABLE RUBBER STOPPER NO. : 7158-3022-80 ETC.

Δ 98.08.04	CHANGED NOTES & DIMENSION	C97-N465	H. K	CUSTOMER		MATL. Δ C2600 (t=0.40)	TREAT. & FIN.
Δ 97.11.10	CHANGED TABLE	C97-8362	T. M	CUSTOMER PART NO.		SPEC. TIN PLATING	
Δ 90.03.06	CHANGED FORM	C90-L254	K. O	CUSTOMER DWG NO.		NAME 312 SEALED TERMINAL MALE	
89.10.11	NEW	C89-M092	H. Y	TRIAL PART NO.			
LET	DATE	REVISION RECORD	NO.	CHKD	VENDOR		
GENERAL TOLFRANCE				VENDOR NO.			
	10MAX	50MAX	100MAX	250MAX	2500VR	ANGLE	ECCENT
A	± 0.15	± 0.2	± 0.3	± 0.5	± 0.75	$\pm 30'$	0.1
B	± 0.2	± 0.3	± 0.55	± 0.95	± 1.4	$\pm 30'$	0.1
(C)	± 0.3	± 0.5	± 0.8	± 1.4	± 2	$\pm 30'$	0.15
SPECIFIED				MASS			
		98.8.27		98.08.26		98.08.17	
		加藤		山梨		幸福	
		87.08.08		98.08.04			
DWG TYPE R				DWG SOURCE NEW		DWG DATE 89.10.19	
UNIT mm				SCL Δ 2/1		ANGLE 3	
PART NO. 7114-6045 ETC.				CH. CODE		DWG NO. 7114-6045:R	
APPROVED				CHECKED		DESIGN SUEYOSHI	
DRAWN				M. YASUDA		SET DWG NO.	
YAZAKI CORPORATION							

ISSUE MARK

