

**注記**  
 ① 適用電線サイズ : CIVUS 0.35~CAVS 0.85, AVS 0.3~0.5  
 ② かん合メス端子品番 : 7116-1680-02

**NOTES**  
 ① APPLICABLE WIRE SIZE : CIVUS 0.35~CAVS 0.85, AVS 0.3~0.5  
 ② MATING FEMALE TERMINAL PART NO. : 7116-1680-02

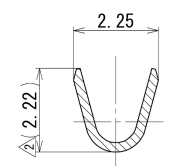

SEC. A-A

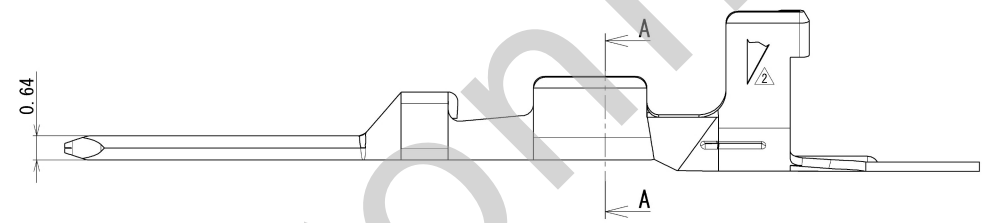
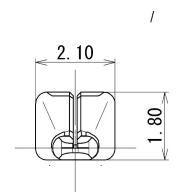
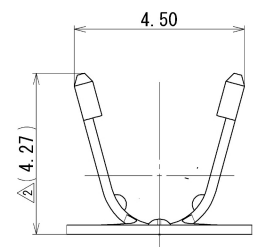

ISSUE MARK

③	2019/04/04	CHANGED APPLICABLE WIRE SIZE, ETC.	C19-P053	Y. M
③	2010/03/25	CORRECTION OF CLERICAL ERROR ETC.	C10-Z158	T. W
③	1990/10/24	CHANGED MATERIAL	C90-7548	M. S
③	1990/09/25	NEW	C90-L993	S. I
LET	DATE	REVISION RECORD	NO.	CHKD

GENERAL TOLERANCE									
	10MAX	50MAX	100MAX	250MAX	2500VR	ANGLE	ECCENT		
A	±0.15	±0.2	±0.3	±0.5	±0.75	±30'	0.1		
B	±0.2	±0.3	±0.55	±0.95	±1.4	±30'	0.1		
③	±0.3	±0.5	±0.8	±1.4	±2	±30'	0.15		
SPECIFIED							MASS	△(0.3) g	

CUSTOMER		MATERIAL SPEC. △ COPPER ALLOY (t=0.25)		TREAT. & FIN. TIN PLATING	
CUSTOMER PART NO.		CUSTOMER DWG NO.			
OFFICE		TRIAL PART NO.		NAME △ SSD TERMINAL MALE	
VENDOR				PART NO. 7114-1680-02	
VENDOR NO.				CH. CODE 7114-1680-02:R	
DWG TYPE	DWG SOURCE	DWG DATE	UNIT	SCL	ANGLE
R	NEW	1990/09/25	mm	10:1	3
APPROVED	CHECKED	CHECKED	DESIGN	DRAWN	
M. NAKAMURA			ISHIZUKA	Y. MAEDA	
2019/04/04			1989/04/06	2019/04/04	
			YAZAKI CORPORATION		